

WIDTH OF EQUIPMENT	HEIGHT OF LEGS
UP TO 24" ³ / ₄ UP TO 600 mm ¹ / ₈	24" ³ / ₄ 600 mm ¹ / ₈
24" TO 48" ³ / ₄ 600 mm TO 1.2 m ¹ / ₈	36" ³ / ₄ 900 mm ¹ / ₈
48" AND WIDER ³ / ₄ 1.2 m AND WIDER ¹ / ₈	48" ³ / ₄ 1.2 m ¹ / ₈

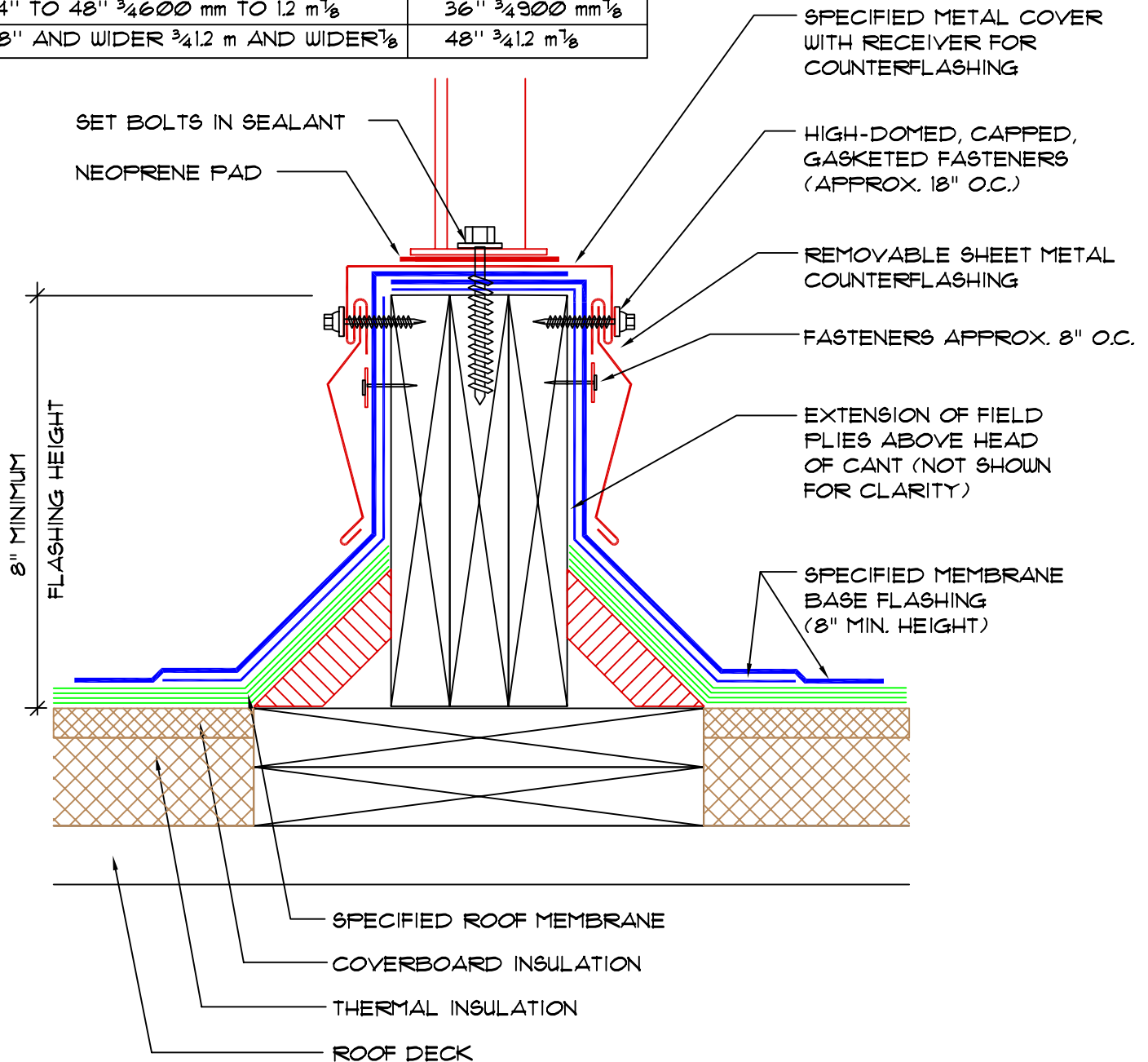

NOTES:

1. A MINIMUM OF 2 FEET OF HORIZONTAL CLEARANCE MUST BE PROVIDED FOR REMOVAL AND REPLACEMENT OF ROOFING AND FLASHING BETWEEN PARALLEL SUPPORTS. A MINIMUM OF 3 FEET OF VERTICAL CLEARANCE FROM ROOF SURFACE TO BOTTOM OF SUPPORTED EQUIPMENT SHOULD ALSO BE PROVIDED.
2. DO NOT USE MODIFIED COAL TAR ON SLOPES THAT EXCEED 1/2" PER FOOT.
3. DO NOT USE TYPE I TAR WITH POLYESTER OR TARRED GLASS FELTS ON SLOPES THAT EXCEED 1/4" PER FOOT, OR WITH TARRED ORGANIC FELTS ON SLOPES THAT EXCEED 1/2" PER FOOT.

detail name:

date: 1/07/04

equipment support curb

detail number: gsd-038

6912 Old Easton Road
Pipersville, PA 18947
215-766-9797

www.greensystemscorp.com



greensystems